

## Hingtgen, Robert J

---

**From:** Hauser, Everett  
**Sent:** Monday, February 03, 2014 8:14 AM  
**To:** Ortiz, Francisco "Nick"; Hingtgen, Robert J  
**Cc:** Sinsay, Edwin M; Hoang, Susan  
**Subject:** RE: SOITEC EIR - TRAFFIC SUMMARY  
**Attachments:** SOITEC Transportation and Traffic Summary Sheet.docx

Attached is the summary sheet.

Feel free to modify as necessary.

---

**From:** Ortiz, Francisco "Nick"  
**Sent:** Thursday, January 30, 2014 1:21 PM  
**To:** Hauser, Everett  
**Cc:** Sinsay, Edwin M; Hoang, Susan  
**Subject:** SOITEC EIR - TRAFFIC SUMMARY

Everett,

Can you please review the attached Soitec EIR documents and prepare a summary that hopefully Rob can use for the CPG meeting.

Please summarize the following:

- The number of construction trips the 4 projects will generate
- The length of the construction phases
- The post-construction traffic the projects will generate
- The roads that the project is expected to use/add traffic to
- Let's check with Ed & Susan for any required road improvements
- Would there potentially be overlapping construction phases so more than one project is generating traffic at the same time?

Let's try to prepare the draft summary by Monday afternoon.

## PDS2012-3910-120005

[http://www.sdcounty.ca.gov/pds/ceqa\\_public\\_review.html](http://www.sdcounty.ca.gov/pds/ceqa_public_review.html)

**Sent:** Tuesday, December 31, 2013 2:30 PM  
**To:** Wilson, Adam; Kohatsu, Sachiko; Gutierrez, Gabriel; Sprecco, Edward; De La Rosa, Michael  
**Cc:** Jones, Megan; Wardlaw, Mark; Gretler, Darren M; Real, Sami  
**Subject:** Release of EIR for Soitec Solar Projects

Hi All,

I just wanted to give you a heads up that the Draft EIR for the Soitec Solar projects in Boulevard is being circulated for public review and comment this Thursday, January 2<sup>nd</sup>. It is a 45-day review that concludes on February 17<sup>th</sup>.

## SOITEC Transportation and Traffic Summary Sheet

---

### TIERRA DEL SOL

Trips: 21,196 over 14 months of construction = 58 Average Daily Trips (ADT)

Daily operations after construction will consist of 6-7 employees = 14 ADT

### RUGGED

Trips: 49,773 over 12 months of construction = 160 ADT

Daily operations after construction will consist of 15-20 employees = 40 ADT

### LAN EAST and LAN WEST

Trips: Construction and post-construction trips estimated to be less than Rugged and Tierra Del Sol

No significant direct impacts from added project traffic. All project roads listed below will continue to operate at LOS A

- Interstate 8
- Old Highway 80
- SR-94
- Ribbonwood Road
- McCain Valley Road
- Tierra Del Sol Road
- Moon Valley Road
- Church Road
- Tierra Real Road
- Tierra Estrella
- Roadrunner Lane

The project will pay TIF to mitigate cumulative impacts

### Permits Required

<http://www.sdcounty.ca.gov/dpw/permitsforms/pfdlist.html>

- Construction (review plans for installation)
- Encroachment (pole/tower installation)
- Excavation (includes County "Pavement Cut Policy" and fees and deposits for inspection and insurance)
- Moving Permit (for oversized vehicles or cargo)

- Traffic Control (ensure safe travel of vehicles within work zone)



Example Traffic Control Plan

which, once reviewed was asked to include the following

language:

1. Applicant shall agree to repair County maintained road(s) damaged by heavy trucks/loads on the haul route. An agreement shall be executed which will include an agreement to: a cash deposit for emergency and permanent road repairs. This amount should be sufficient to ensure adequate repairs to the haul route can be completed.
2. The condition of the road shall be determined before and after the haul and provided to the County for review.
3. County maintained roads shall be swept each day at the end of each work shift. Haul hours shall be adjusted to reflect this requirement.
4. Equipment and material storage shall not be allowed on the roadway at any time.
5. Contractor/Developer shall agree to restore the roadway to original condition or better. Including but not limited to: asphalt dikes, berms, swales, concrete curb & gutter, concrete cross-gutters, concrete sidewalks.
6. Appropriate stormwater BMP's should be implemented and maintained at drainage system inlets and as needed.
7. A final walk-through shall be performed with the RCS after the haul is complete.
8. There should be a condition that addresses day of weeks and hours of operation for construction activities

**GENERAL NOTES**

OPERATORS OF GRAVITY SEWER SYSTEMS AND CERTAIN OTHER UTILITIES, WHO ARE NOT MEMBERS OF UNDERGROUND SERVICE ALERT, MUST BE INDIVIDUALLY CONTACTED.

CONTRACTOR TO ENSURE ADEQUATE SIGHT DISTANCE AT INTERSECTING DRIVEWAYS AND SIDE STREETS. IN LOCATIONS OF RESTRICTED SIGHT DUE TO STOCKPILES OR CONSTRUCTION EQUIPMENT, THE CONTRACTOR SHALL POST FLAGGERS WITH APPROPRIATE TRAFFIC CONTROL SIGNAGE AT THOSE LOCATIONS TO CONTROL TRAFFIC AND PEDESTRIAN MOVEMENT IN A SAFE MANNER. SIGNAGE AND FLAGGERS SUBJECT TO REVIEW AND ADJUSTMENT AT THE DIRECTION OF THE COUNTY INSPECTOR.

**TRAFFIC CONTROL NOTES**

- VALIDATION: THIS TRAFFIC CONTROL PLAN IS NOT VALID UNTIL WORK DATES ARE APPROVED. THE CONTRACTOR SHALL SUBMIT AN APPLICATION TO THE COUNTY OF SAN DIEGO DPW TRAFFIC ENGINEERING SECTION, TRAFFIC CONTROL PERMITS, 5510 OVERLAND AVENUE, SUITE 410 (MS 0334), SAN DIEGO CA, 92123-1239 (PHONE NUMBER 1-858-694-3928) FOR A TRAFFIC CONTROL PERMIT AT LEAST THREE WEEKS PRIOR TO COMMENCEMENT OF WORK. THERE IS NO FEE FOR THIS PERMIT.
- STANDARDS: THIS TRAFFIC CONTROL PLAN SHALL CONFORM TO THE MOST RECENT ADOPTED EDITION OF EACH OF THE FOLLOWING MANUALS:
  - CALIFORNIA MANUAL OF UNIFORM TRAFFIC CONTROL DEVICES (CAMUTCD) 2010 EDITION.
  - SAN DIEGO AREA REGIONAL STANDARD DRAWINGS, APPENDIX A-TRAFFIC CONTROL PLANS (MOST CURRENT EDITION).
  - APWA "WATCH MANUAL"
 THESE MANUALS CAN BE FOUND AT THE FOLLOWING RESPECTIVE WEBSITES:  
[http://www.dot.ca.gov/hq/traffops/signtech/mutcdsupp/ca\\_mutcd2010.htm](http://www.dot.ca.gov/hq/traffops/signtech/mutcdsupp/ca_mutcd2010.htm)  
<http://www.regional-stds.com/home/book/drawings/appendix-a>  
[http://www.dot.ca.gov/hq/traffops/devicessery/permits/encroachment\\_permits\\_manual/index.html](http://www.dot.ca.gov/hq/traffops/devicessery/permits/encroachment_permits_manual/index.html)
- NOTIFICATIONS: THE CONTRACTOR SHALL NOTIFY PROPERTY OWNERS AND TENANTS A MINIMUM OF (7) SEVEN DAYS PRIOR TO CLOSURE OF DRIVEWAY. THE CONTRACTOR SHALL POST SIGNS NOTIFYING THE PUBLIC A MINIMUM OF SEVEN (7) WORKING DAYS PRIOR TO START OF TRAFFIC CONTROL.  
 THE CONTRACTOR SHALL NOTIFY THE FOLLOWING AGENCY A MINIMUM OF TWO (2) WORKING DAYS PRIOR TO EXCAVATION, CONSTRUCTION, OR TRAFFIC CONTROL:  
 UNDERGROUND SERVICE ALERT (ANY EXCAVATION) 1-800-227-2600 OR 811.  
 THE CONTRACTOR SHALL NOTIFY THE AFFECTED EMERGENCY SERVICES AT LEAST ONE WEEK IN ADVANCE:  
 LAKESIDE FIRE PROTECTION DISTRICT (619) 390-2350  
 SHERIFF (658) 565-5262 AND (619) 659-2800  
 CHP (619) 401-2000
- RESTORATION OF TRAFFIC CONTROL DEVICES: THE CONTRACTOR SHALL REPAIR OR REPLACE TRAFFIC CONTROL DEVICES (INCLUDING TRAFFIC SIGNS, STRIPING, PAVEMENT MARKERS, LEGENDS, CURB MARKINGS, LOOP DETECTORS, SIGNAL EQUIPMENT, ETC.) DAMAGED OR REMOVED AS RESULT OF OPERATIONS AND NOT DESIGNATED FOR REMOVAL. REPAIRS AND REPLACEMENTS SHALL BE EQUAL TO EXISTING IMPROVEMENTS. LOOP DETECTORS SHALL BE REPLACED WITHIN (3) WORKING DAYS OF COMPLETION OF UNDERGROUND WORK, AS DIRECTED BY COUNTY REPRESENTATIVE.
- CHANGES IN WORK: THE RESIDENT ENGINEER WILL OBSERVE THESE TRAFFIC CONTROL PLANS IN OPERATION AND RESERVES THE RIGHT TO MAKE ANY CHANGES AS FIELD CONDITIONS WARRANT. SUCH CHANGES SHALL SUPERSEDE THESE PLANS.
- SELECTED TRAVEL STOPS IN THE WORK ZONE MAY BE CLOSED FOR ONE DAY MAXIMUM. CONTRACTOR SHALL CONTACT MTD&B AND SHALL POST WARNING SIGNS AT LEAST FIVE DAYS IN ADVANCE OF CLOSURE. SIGNS SHALL INDICATE DATES AND TIMES OF CLOSURE.
- WORK SCHEDULE: DAY OPERATIONS - 7:00 AM TO 5:00 PM
- FOR COMMERCIAL DRIVEWAYS, IF TWO EXIST, ONE MAY BE TEMPORARILY CLOSED.
- ALL TEMPORARY SIGNS TO BE MOUNTED ON TYPE III BARRICADES, UNLESS IDENTIFIED DIFFERENTLY ON THE PLANS. SAND BAGS SHALL BE PLACED ON BASES FOR STABILITY.
- CONES/DELINEATORS SHALL BE ORANGE IN COLOR, 36" HIGH AND HAVE RETROREFLECTIVE BANDS.

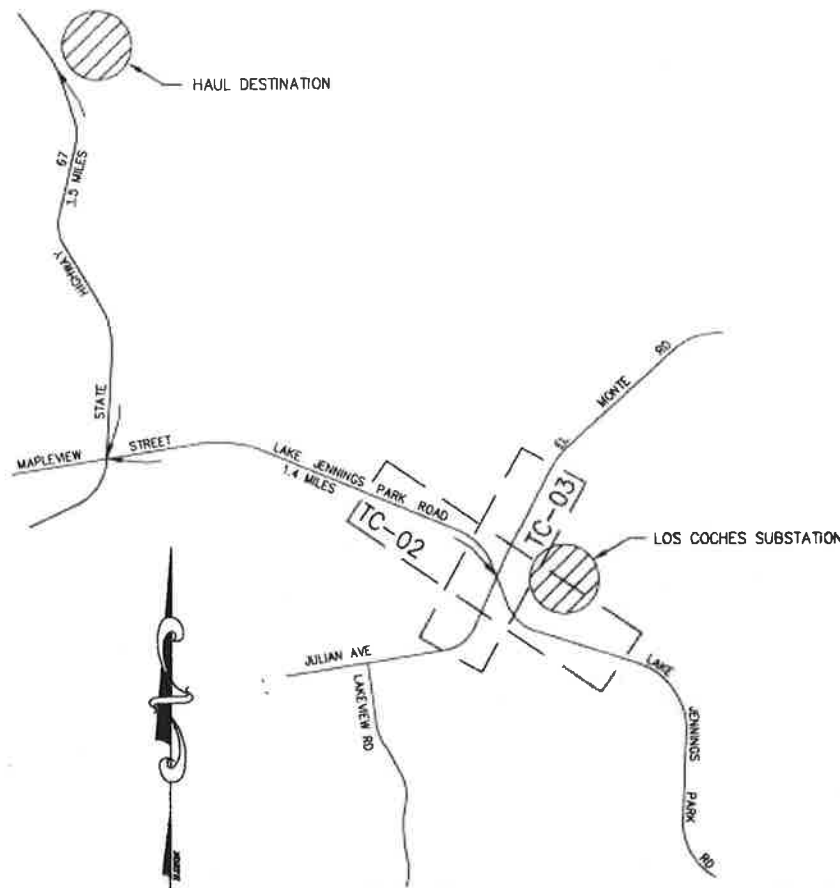

VICINITY MAP  
NO SCALE

**TRAFFIC SIGN CHART \***

\* ALL PORTABLE SIGNS TO BE ANCHORED WITH SANDBAGS

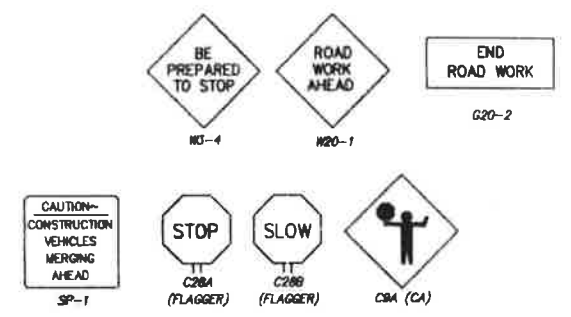

**TRAFFIC CONTROL LEGEND**

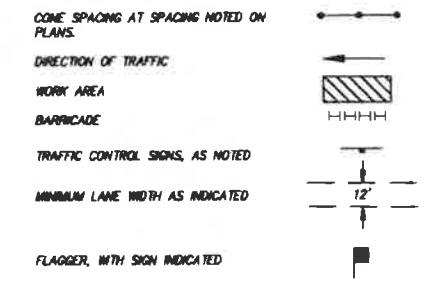

**HAUL DESTINATION**

SUPERIOR TRIPLE T QUARRY  
12404 HIGHWAY 67  
LAKEVIEW, CA 92040

**HAUL ROUTE**

EXIT SITE LEFT (SOUTHERLY) ONTO EL MONTE ROAD;  
RIGHT (WEST) ONTO LAKE JENNINGS PARK ROAD/MAPLEVIEW STREET;  
RIGHT (NORTH) ONTO HIGHWAY 67 TO TRIPLE T QUARRY.

**HAUL TRIPS PER DAY/DURATION**

APPROXIMATELY 100 TRIPS PER DAY  
FOR APPROXIMATELY 17 WEEKS

**HAUL HOURS**

MONDAY THROUGH FRIDAY  
7:00am TO 5:00pm

**HAUL LOAD WEIGHT**

APPROXIMATELY 18 TO 21 TONS (36,000 TO 42,000 LBS.)

REVISIONS

NO.	WORK DONE	DATE	BY:	APP'D:	REL.	NO.	WORK DONE	DATE	BY:	APP'D:	REL.	NO.	WORK DONE	DATE	BY:	APP'D:	REL.

SAN DIEGO GAS & ELECTRIC COMPANY  
SAN DIEGO, CALIFORNIA

LOS COCHES SUBSTATION MODIFICATION  
TRAFFIC CONTROL NOTES & DETAILS

DESIGNED BY: DATE: SCALE: N/A REG: REV: BY:  
 CHECKED BY: DATE: SHEET 1 OF 37  
 APPROVED BY: DATE: PLOT SCALE: 1:1  
 CNO NO.:

TC-01

C:\USERS\JMEYERS\Desktop\LOS COCHES TRAFFIC.TXD



