

SEE SHEET 1

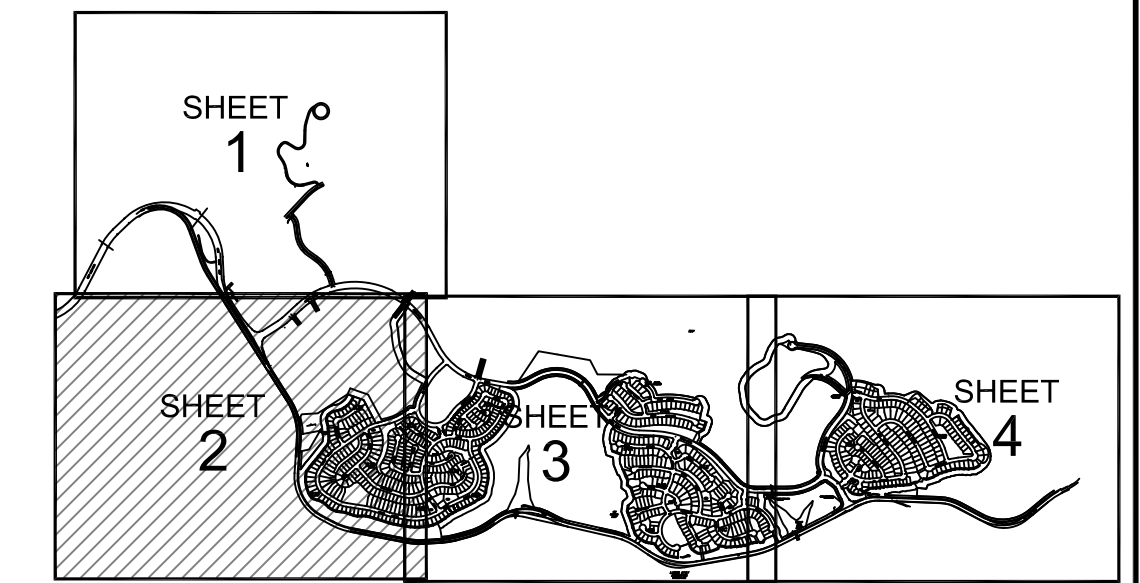

INDEX MAP  
NO SCALE

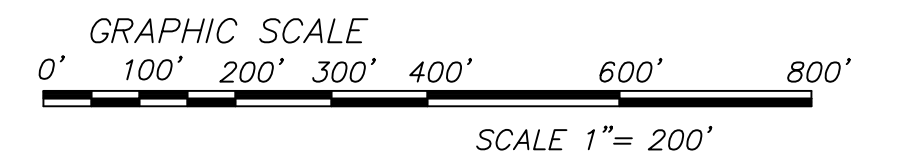
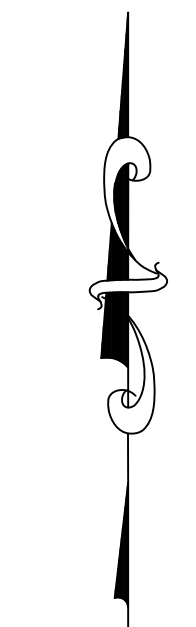

SEE SHEET 3

**GEOCON LEGEND**

- Qdf** ..... UNDOCUMENTED FILL
- Qal** ..... ALLUVIUM
- Qal** ..... OLDER ALLUVIUM
- Ql** ..... LACUSTRINE DEPOSITS
- Tof** ..... FANGLOMERATE DEPOSITS
- To** ..... OTAY FORMATION
- Kjmv** ..... METAVOLCANIC ROCK
- ..... APPROX. LOCATION OF GEOLOGIC CONTACT (Queried Where Uncertain)
- AT-22 ..... APPROX. LOCATION OF AIR TRACK BORING
- AH-10 ..... APPROX. LOCATION OF PREVIOUS AIR TRACK (Neblett & Associates, 2004)
- ET-40 ..... APPROX. LOCATION OF EXCAVATOR TRENCH
- NT-47 ..... APPROX. LOCATION OF PREVIOUS BACKHOE TRENCH (Neblett & Associates, 2004)
- SL-18 ..... APPROX. LOCATION OF SEISMIC LINE
- S-17 ..... APPROX. LOCATION OF PREVIOUS SEISMIC LINE (Neblett & Associates, 2004)
- NB-2 ..... APPROX. LOCATION OF PREVIOUS BORING (Neblett & Associates, 2004)
- LB-17 ..... APPROX. LOCATION OF LARGE DIAMETER BORING
- SB-10 ..... APPROX. LOCATION OF SMALL DIAMETER BORING
- T-71 ..... APPROX. LOCATION OF TRACKHOE TRENCH
- ..... STRIKE AND DIP OF JOINT
- ..... VERTICAL JOINTING
- ..... STRIKE AND DIP OF FOLIATION
- ..... VERTICAL FOLIATION
- ..... APPROX. LOCATION OF GEOLOGIC CROSS-SECTION
- ..... APPROX. LOCATION OF PROPOSED SUBRAIN
- ..... ESTIMATED REMOVAL DEPTH FOR REMEDIAL GRADING (in Feet)
- ..... ESTIMATED THICKNESS OF CAPPING MATERIAL AFTER SCREENING (in Feet)
- ..... ESTIMATED RIPRAP DEPTH DURING GRADING (in Feet)

**GEOLOGIC MAP**  
OTAY RANCH RESORT VILLAGE  
AREA B TENTATIVE MAP  
SAN DIEGO COUNTY, CALIFORNIA

<b>GEOCON</b> INCORPORATED GEO TECHNICAL CONSULTANTS 6960 FLANDERS DRIVE - SAN DIEGO, CALIFORNIA 92121-2974 PHONE 858 558-6900 - FAX 858 558-6159	SCALE 1" = 200' PROJECT NO. G1012-52-01C SHEET 2 OF 4	DATE 09-19-2014 FIGURE 3
---	---	-----------------------------