

COUNTY OF SAN DIEGO TRACT TM
TENTATIVE MAP
NEWLAND SIERRA



LINE TABLE		
NO.	BEARING	DISTANCE
L1	N0°16'45"W	151.77'
L2	N89°59'43"W	24.14'
L3	N25°24'56"W	143.67'
L4	N3°51'43"W	200.00'
L5	N41°07'57"E	287.28'
L6	N48°24'48"E	148.83'
L7	N89°54'29"E	162.13'
L8	N87°25'49"W	86.56'
L9	N37°34'25"W	30.30'
L10	N73°12'40"W	150.28'
L11	N35°36'30"W	59.20'
L12	N50°17'38"E	248.50'
L13	N63°51'42"E	121.08'
L14	N78°48'33"W	191.78'
L15	N30°51'01"E	27.71'
L16	N8°49'38"W	64.21'
L17	N89°02'25"W	70.13'
L18	N71°29'39"W	44.39'
L19	N8°07'43"W	20.71'
L20	N34°01'10"W	45.00'
L21	N9°30'30"E	67.42'
L22	N8°13'26"W	277.54'
L23	N28°23'11"W	41.91'
L24	N53°04'28"W	409.07'
L25	N88°50'43"E	22.06'
L26	N8°57'04"W	10.33'
L27	N0°49'34"E	338.58'
L28	N61°18'33"E	52.09'
L29	N78°03'41"W	75.88'
L30	N53°43'05"W	28.02'
L31	N0°48'02"E	34.81'
L32	N48°41'55"W	199.62'
L33	N87°30'10"E	67.93'
L34	N50°52'16"W	30.30'
L35	N70°25'41"W	86.82'
L36	N2°56'23"E	37.00'

CURVE TABLE			
NO.	DELTA	RADIUS	LENGTH
C1	49°51'16"	100.00'	87.01'
C2	35°38'15"	100.00'	62.20'
C3	37°36'10"	180.00'	118.13'
C4	84°05'52"	50.00'	82.12'
C5	13°14'04"	150.00'	34.65'
C6	37°39'45"	260.00'	170.91'
C7	70°50'26"	60.00'	73.66'
C8	38°40'39"	130.00'	90.03'
C9	62°34'42"	50.01'	54.61'
C10	63°21'56"	100.00'	110.59'
C11	25°53'23"	210.00'	94.89'
C12	43°31'40"	80.00'	60.78'
C13	17°43'56"	205.00'	63.44'
C14	20°09'45"	510.00'	179.47'
C15	24°41'17"	50.00'	21.54'
C16	40°04'49"	70.00'	48.92'
C17	85°47'47"	50.00'	83.60'
C18	9°46'38"	550.00'	93.85'
C19	60°28'59"	100.00'	105.56'
C20	40°37'46"	50.00'	35.46'
C21	24°20'36"	70.00'	29.74'
C22	54°31'57"	50.00'	47.59'
C23	49°10'47"	100.00'	86.42'
C24	43°47'55"	100.00'	76.44'
C25	41°57'34"	100.00'	73.23'
C26	19°53'25"	70.00'	24.30'
C27	230°03'57"	54.00'	216.85'

OPEN SPACE NET LOT AREAS		
LOT	SQUARE FEET	ACRES
OS-5	10,374,379	238.16
OS-6	7,913,515	181.67
OS-7	8,333,793	189.02
OS-8	11,407,155	261.87
OS-9	2,733,529	62.75
OS-10	3,392,381	77.88
OS-11	895,180	20.55
OS-13	429,358	9.86

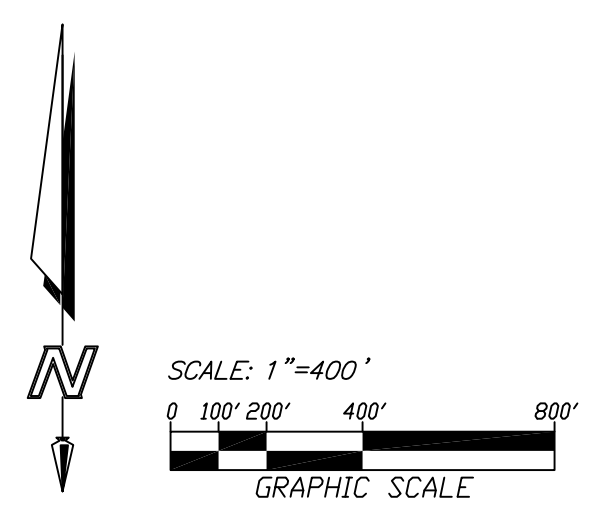
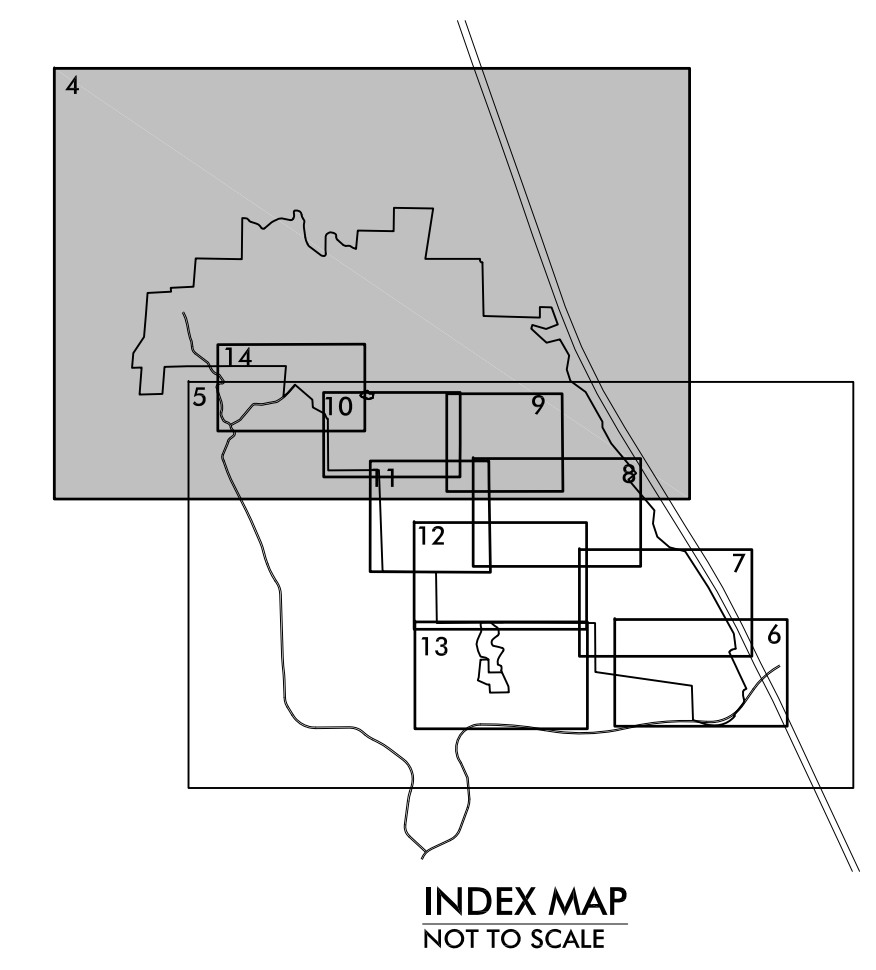

SEE SHEET 5

SHEET 4 OF 14

ENGINEER OF WORK
FUSCOE ENGINEERING
6390 GREENWICH DRIVE, STE. 170
SAN DIEGO, CA 92122
(619)554-1500



ERIC K. ARMSTRONG RCE 36083 DATE